

# Box Connector Operation Manual

SHARP CORPORATION

Table of Contents

1 Overview ..... 3

2 Usage Notes ..... 4

3 Verifying System Requirements..... 5

4 Setup the MFP ..... 6

    4.1 Install Box connector on MFP ..... 6

    4.2 Register the connector icon on the home screen ..... 7

5 Use Box Connector..... 8

    5.1 Upload scan data to Windows ..... 8

    5.2 Printing data in Box..... 9

## 1 Overview

Box connector is a Sharp OSA application that

- Uploads scanned documents from your MFP to Box
- Prints the documents and photos stored in your Box to your MFP

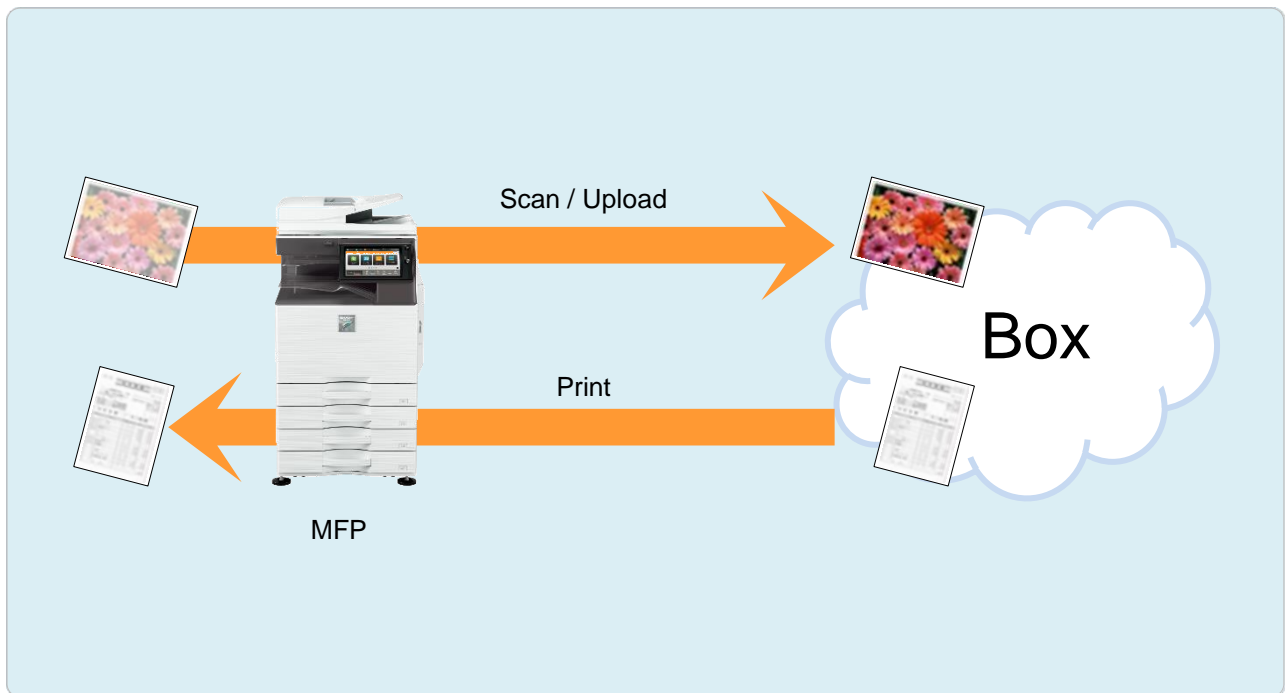

## 2 Usage Notes

- Box connector communicates between the storage server on the Internet and the MFP.  
Please confirm the access restriction from the internet and change the administrator's password for MFP as needed.
- The quality of print results by Box connector may differ from those by the other print methods (such as printer driver).  
In addition, it may not be printed properly or printing may not be available depending on the file contents.
- All or part of the print feature may not be available depending on the country or region you use MFP.
- Depending on your network environment for using MFP, connecting function to Box may not be available. Even if they are available it may take a while to print the contents, or communication may be interrupted while operation is in progress.
- SHARP does not guarantee the continuity or stability of connecting function with Box.  
Please note that SHARP assumes no responsibility for any damages accordingly caused to customers unless otherwise it is deemed to be statutorily liable.
- Please note that screen designs are subject to change without notice.
- The contents of this manual may not be reproduced or duplicated, in whole or in part, without permission of SHARP Corporation.
- The contents of this manual are subject to change for improvement without notice.

All trademarks are the property of their respective owners.

### 3 Verifying System Requirements

Before setup, make sure that your environment satisfies the following requirements.

- MFP:  
Set the IP address, Subnet mask, Default gateway, DNS server, and Proxy server, etc.
- Box accounts:  
Use for activating Box connector on MFP.

## 4 Setup the MFP

This chapter explains the procedure for making the MFP available for Box connector.

### 4.1 Install Box connector on MFP

1. Copy the Box connector (files with the extension ".emo") to your PC's HDD.
2. Start the web browser on your PC.
3. Log in to the MFP's device web page with administrator authority and open [System Settings] - [Sharp OSA Settings] - [Embedded Application Settings].
4. Click [Add] button.
5. [Installation of Embedded Application] page is displayed.  
Click [Browse] button, select the file copied in step 1, and click [Execute] button.
6. [Confirm Application] page is displayed.  
Confirm the details, and click [Execute] button.  
When the [Register as Standard Application] check Box is checked, the MFP executes the registration process to the standard application at the same time as the installation process.  
Except when any special cases exist, we recommend checking this check Box.

When installation is successful, [Box] will be displayed in the application list of the [Embedded Application Settings] page.

In addition, if you check the [Register as Standard Application] check Box in step 6, [Box] is displayed in the application list on the [System Settings] - [Sharp OSA Settings] - [Standard Application Settings] page.

## 4.2 Register the connector icon on the home screen

In order to use the installed Box connector, you need to register the application icon of the application on the home screen as follows.

1. Start the web browser on your PC.
2. Log in to the MFP's device web page with administrator authority and open [System Settings] - [Home Screen Settings] - [Condition Settings].
3. Please click on any link from the [Home button] list.
4. [Home Screen Registration] page is displayed.  
Select [Sharp OSA] - [Application], then, select [Box] from select Box.
5. Click [Submit] button.

When registration is successful, [Box] will be displayed on the home screen.

## 5 Use Box Connector

### 5.1 Upload scan data to Windows

This section explains how to upload data scanned on the machine to Box.

1. Tap [Box] in the home screen.

The login screen appears.

When user authentication is enabled on the machine, the login screen will not appear after the first time you successfully log in to Box.

2. Enter your user account information for Box.

3. When login is successful, the screen of Box connector will be displayed

Specify a "File Name", "Address", and "Upload Data Scan Settings" on [Scan settings screen].

NOTE: When the [Print ] or [Upload ] icon is tapped, [Print setting screen] or [Scan setting screen] is displayed.

4. Execute Scan or Preview.



## 5.2 Printing data in Box

This section explains how to use the machine to print data in Box.

1. Tap [Box] in the home screen.



The login screen appears.

When user authentication is enabled on the machine, the login screen will not appear after the first time you successfully log in to Box.

2. Enter your user account information for Box.

3. When login is successful, the screen of Box connector will be displayed

Specify a "file to be printed", and "Print Settings" on [Print settings screen].

NOTE: When the [Print ] or [Upload ] icon is tapped, [Print setting screen] or [Scan setting screen] is displayed.

1. Execute printing.

The printable formats are DOCX, PPTX, XLSX, PDF, PS, PRN, PCL, TIFF, TIF, JFIF, JPE, JPEG, JPG and PNG. This is limited to machines which can print DOCX, XLSX and PPTX files.